



J3671MDR



J3671MDR

CASECARE +



Combination Storage/Wardrobe Cabinet
Three Adjustable, Two Fixed Shelves on Left,
Hanger Rail Wordrobe Unit on Right w/Shelf.

CaseCare+ cabinets are designed specifically for the healthcare environment. They feature durable E-Z clean thermal-fused exterior and interior laminates in a choice of solid color or wood grained finishes.

The tubular steel legs provide a clear space for cleaning while protecting the furniture. Drawers operate on lifetime guaranteed full suspension, plated metal slides and can be easily wiped clean with a damp cloth.

Options include interior door mirrors, 3" dia. soft tread locking wheels, traditional detailed bases, replaceable tops, fully finished solid backs and a choice of drawer pulls.



Adjustable Swing Door Latches

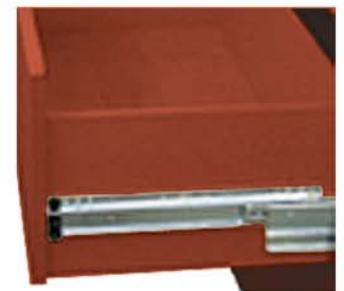

Removable Full Suspension Drawers



Executive Office Concepts • Elements of Care

CASECARE +



J2030RC-3C

Casecare+ complies with CARB, California's latest green certification requirement, which includes the reduction and elimination of Formaldehyde in solid wood core panels.

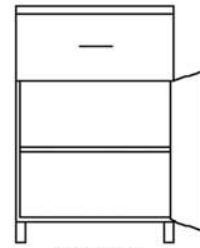

J2030TDC

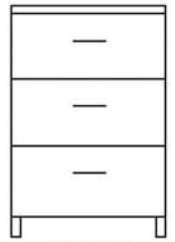

J2030RC



63 Natural Maple



70 Pearwood



57 Honey Cherry



61 Victorian Cherry



66 Mahogany



17 White



44 Haze



48 Fashion Grey



58 Charcoal



14 Black



J3630RC

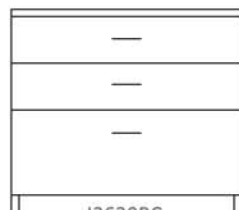

J3630RC

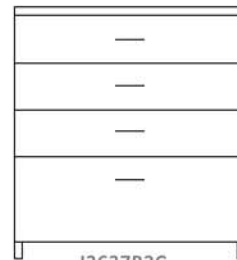

J3637R3C

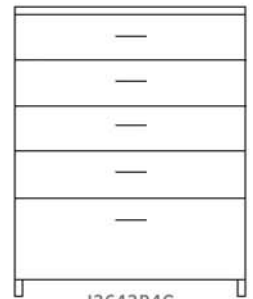

J3643R4C

